

## Operations and Maintenance Manual Wetherby Modular Insulated Brick Slip System



# Operations and Maintenance Manual - Content

| Section   | Page |
|---|------|
| 1.0 Wetherby Modular Insulated Brick Slip System Information  | 1    |
| 2.0 Wetherby Aftercare and Maintenance                        | 2    |
| 2.1 Silicone Sealant  | 2    |
| 2.2 Garden and Plant Consideration                            | 2    |
| 2.3 General Considerations                                    | 2    |
| 2.4 Damage to the System                                      | 2    |
| 3.0 Additions to the EWI System                               | 3    |
| 3.1 Detailing of Additions                                    | 3    |
| 3.2 Fixtures and Fittings                                     | 3    |
| 3.3 Satellite Dish Installation                               | 3    |
| 3.4 Addition of Metalwork                                     | 3    |
| 3.5 Pipes and Vents   | 3    |
| 3.6 Replacement of Existing Windows                           | 4    |
| 3.7 Addition of New Doors and Windows                         | 4    |
| 3.8 Canopies, Outhouses and Lean-Tos                          | 4    |
| 3.9 Extensions and Conservatories                             | 4    |
| 4.0 General Maintenance and Cleaning of the Brick Slip System | 5    |
| 4.1 Pressure Washing  | 5    |
| 4.2 Dust Marks / Minor Aesthetically Damaged Areas            | 5    |
| 4.3 Mortar Marks  | 5    |
| 4.4 Damaged Brick Slips                                       | 5    |
| 4.5 Severe System Damage                                      | 5    |
| 5.0 Patch Repair of the Insulated Brick Slip System           | 6    |
| 6.0 Wetherby System Products                                  | 10   |
| 6.1 Wetherby SWI-FIX Spacers                                  | 11   |
| 7.0 Contact Information                                       | 12   |



# Wetherby Modular Insulated Brick Slip System

## 1.0 Wetherby Modular Insulated Brick Slip System Information

The Modular Brick Slip System is a unique lightweight cladding system providing a real brick finish.

The system comprises of mechanically fixed insulation boards. Brick slip adhesive is trowel applied to the insulation boards and used to wet fix each slip to the boards before pointing mortar is applied in the desired colour and style.



### Wetherby Modular Insulated Brick Slip System

- Timber / Steel Frame Substrate
- Timber Battens / Cavity Spacer Rails
- Wetherby Ribbed EPS Insulation Board
- Wetherby Approved Mechanical Fixings
- Wetherby Brick Slip Adhesive
- Wetherby Brick Slip
- Wetherby Pointing Mortar

### Brick Slip Finishes:-



Almenara



Anoreta



Staffordshire Blue



Laguna



Hermosa



Hermosa

# Wetherby Modular Insulated Brick Slip System

## 2.0 Aftercare and Maintenance

### 2.1 Silicone Sealant

Wetherby specify a 25 year minimum life expectancy silicone sealant for their brick slip systems to ensure long term protection against water ingress. Where Wetherby EVO-STIK Silicone Sealant or an equivalent Wetherby approved sealant is used and applied as instructed, this extended life expectancy means minimal checks will be required to silicone sealant during the systems design life.

During periodic inspections, should any damage to sealant be observed this should be removed and be reinstated with Wetherby approved 25 year minimum life expectancy sealant to ensure the integrity of the system is maintained.

### 2.2 Garden and Plant Consideration

Keep garden soil levels as far below the system as possible as soil splashing will discolour the base of the system over time. Plants, trees and creepers can cause staining of finishes and care should be taken in the positioning of them. Climbing plants, provided they have the properly fixed trellis, will not cause any damage to the system, however some staining may be caused.

### 2.3 General Considerations

Metal objects should be kept away from the insulated brick slip system and not leaned up against the system. Rust staining can soon discolour the finish and damage the system.

Dripping overflows and splashes from leaking gutters and down-pipes can soon mark and stain the brick slip finish. Such leaks should be repaired as soon as possible to prevent water staining.

Care should be taken when handling heavy objects, for example dustbins, near the brick slip system. Although the system is highly resistant to damage, these types of objects particularly near corners can cause some damage, which is visually undesirable although easily repairable.

### 2.4 Damage to the System

Any damage to the EWI system must be repaired immediately as per the information in this document. Any cracks in slips or pointing mortar exceeding 0.2mm must be investigated to assess the cause and repaired as appropriate. Damage to the brick slips should be repaired in a short time frame to prevent further damage to the area. Damage to the insulation will require immediate repair to prevent water ingress into the system. Please see Section 4 & 5 of this document for further information on repair procedures.

# Wetherby Modular Insulated Brick Slip System

## 3.0 Additions to the EWI System

### 3.1 Detailing of Additions

---

Carefully choose any further additions to the property that are to be added after the insulated brick slip system is complete. Drain-off from poorly designed or poorly installed items such as canopies, lights, alarm boxes, hanging baskets, etc., will stain the substrate. Water should always be channelled away from the brick slip surface and not allowed to streak down the system face or pool against the system. Additions creating a flat ledge are advised against as water and dirt will splash up and soak the area, creating staining and possibly damage to the system.

### 3.2 Fixtures and Fittings

---

Wetherby advise fixtures & fittings are installed in one of the following ways...

- 1) Drill out approximately sized holes through the system back into the existing substrate and clean out any loose material. Insert SWI-FIX tension spacers at the relevant fixing points. The fixtures may then be installed as normal but should be evenly tightened against the spacers and not the brick slip system. Wetherby EVO-STIK Silicone Sealant must be neatly applied around the spacers to ensure water penetration is prevented.
- 2) Install specialist insulation fixings through the EWI system into the main substrate as per manufacturer's instructions. Drill a suitably sized hole and clean out the area. Install the fixing ensuring the thermal barrier is flush with the brick slip finish. Screw in the fixing and seal using Wetherby EVO-STIK Silicone Sealant where required. Mount the fixture and hand tighten the screw.

(Wetherby approved fixings must be used, please contact the Technical department for further information).

### 3.3 Satellite Dish Installation

---

If fitting a satellite dish to completed areas of the external wall insulation system, please use the fixing method as above (section 3.2) ensuring the dish is securely fixed back to the substrate and movement is restricted. Specialist SWIFIX spacers and appropriate fixings are available from Wetherby. All fixings must be suitably sealed with Wetherby EVO-STIK Silicone Sealant.

### 3.4 Addition of Metalwork

---

Any metalwork to be added to the building such as clothes line hooks should be well painted or otherwise protected if they are made from a ferrous metal. Attachment to the building should be made with fixings which penetrate through the system and into the substrate, for example sleeved bolts or extended length fixings. These should be sealed at their abutment with the system using Wetherby EVO-STIK Silicone Sealant.

### 3.5 Pipes and Vents

---

Any additional pipes or vents which penetrate the system should be passed through holes in the insulated brick slips (max. 5mm larger than the pipe diameter), finishing proud of the brick slip system. Wetherby EVO-STIK Silicone Sealant can then be used to seal between the pipes and brick slips ensuring water penetration is prevented.

# Wetherby Modular Insulated Brick Slip System

## **3.6 Replacement of Existing Windows**

---

Where doors or windows are to be replaced after installation of the system, it is always the preferred option to replace internally to minimize damage to the EWI and brick slips. Care must be taken not to damage the system in the reveals on removal or replacement and the new door / window will need to be resealed against the system, potentially involving patching replacing brick slips / pistols, but always using Wetherby EVO-STIK Silicone Sealant to ensure long term water tightness. Any damage to the insulated brick slip system should be repaired in line with Wetherby guidance.

## **3.7 Addition of New Doors / Windows**

---

Where new doors, windows or other openings are to be cut into the structure, the system must be layered back by a full brick slip, away from the opening. New Wetherby materials should be applied in sequence neatly back to the new fitment or opening. See the Wetherby Patch Repair Guide (Section 5.0) for further information.

## **3.8 Canopies, Outhouses and Lean-Tos**

---

Any additions to the property to be fixed to the EWI system, for example canopies, outhouses or lean-tos, should be sealed where it abuts the system using Wetherby EVO-STIK Silicone Sealant. Water penetration into the system must be prevented at all times. Appropriate fixing methods should be used as per Wetherby guidance. The Wetherby Detailing of Additions guidance (Section 3.1) should be followed, taking advice on water runoff and stain prevention.

## **3.9 Extensions and Conservatories**

---

Any additions requiring the EWI system to be cut back should be completed by layering back the system to the nearest full brick slip. Please see the Wetherby Patch Repair Guide (Section 5.0) for further information. The system will need to be re-sealed against the new substrate or completed with use of a stop bead to fully seal the system. The roof abutment must be completed as per Wetherby detail drawings, please contact the Wetherby Technical department for further information.

# Wetherby Modular Insulated Brick Slip System

## 4.0 General Maintenance and Cleaning

### 4.1 Pressure Washing

---

Where staining has occurred, a pressure wash can be used to clean the face of the Brick Slip System. The pressure washer should be set at 100 bar maximum and used no closer than 1 meter from the brick slips to ensure the brick slips and pointing mortar are not damaged during the cleaning process. A sample panel should always be completed first to assess the impact and potential damage from pressure washing.

### 4.2 Small Dust Marks / Minor Aesthetically Damaged Areas

---

Mild soapy water and a soft brush may remove small areas of cement dust, soil, scuff marks etc., however it must be stressed that this action may also worsen the problem. A small test panel should always be completed first.

### 4.3 Mortar Marks

---

Mortar can be removed from the brick slips using a mild brick acid wash. The mortar should firstly be removed as far as possible and then brick acid wash applied, as per the manufacturer's instructions, to the brick face. The acid wash should not be applied to the pointing mortar and these areas should be protected as far as possible when cleaning the brick slips. Always complete a test panel before applying brick acid wash to larger areas to ensure there is no colour change to the brick slips. Please contact Wetherby Technical for further information.

### 4.4 Damaged Brick Slips

---

Where isolated brick slips have been damaged or removed, slips may be replaced as long as the insulation is not damaged in anyway. Brick slips can simply be adhesively fixed using Wetherby Brick Slip Adhesive and pointed in as normal. Where the insulation has been damaged please refer to the Patch Repair section of this document (Section 5.0).

### 4.5 Severe System Damage

---

In areas where the insulation has been damaged and brick slips have been removed / broken, please refer to the Patch Repair of the Brick Slip System section of this document for full patch repair guidance (Section 5.0).



# Wetherby Modular Insulated Brick Slip System

## 5.0 Patch Repair

Records and photographs should be kept of damaged areas and the various stages of the repair process. Repairs should be completed by a Wetherby recognised contractor.



1. Example damage to system.
2. Remove all full brick slips required to fully expose damaged insulation, ensuring enough room is left for brick slips to be properly patched in.



3. Clean area and remove all remaining brick slip adhesive.
4. Carefully cut out damaged insulation in a neat square / rectangle ready for new insulation to be cut and inserted.



# Wetherby Modular Insulated Brick Slip System

## Patch Repair



5. Cut off any mechanical fixings level with the original structure. Ensure substrate/timber battens are in suitable condition to receive new product.
6. Cut insulation and install to fit tightly against existing insulation. Mechanical fix Wetherby approved fixings ensuring the board is securely held and supported. A minimum ratio of 8 fixings per m2 must be used.



7. Foam fill any gaps around the insulation larger than 2mm and allow to fully cure before applying Wetherby Brick Slip Adhesive. Cut foam level with insulation.

# Wetherby Modular Insulated Brick Slip System

## Patch Repair



8. Apply Wetherby Brick Slip Adhesive to the back of each brick slip ensuring a full bed of adhesive.
9. Position slips in place leaving a consistent joint as per existing slips. Spacers are advised to hold the slip in place whilst the adhesive sets.



10. Allow slips to fully set before removing spacers.
11. Point in slips with Wetherby Pointing Mortar using a pointing gun or piping bag. Take care not to apply mortar to the brick slip face as it is extremely difficult to remove.



# Wetherby Modular Insulated Brick Slip System

## Patch Repair



12. Shape mortar to the desired joint type using a pointing trowel.
13. Once Wetherby Pointing Mortar has set, brush down surface to remove all loose material.

Failure to action the repair to the EWI system in event of damage, water ingress or failure of sealant in accordance with this manual may result in the system guarantee becoming invalid. Should you have any queries regarding the above items please contact the Wetherby Technical Department.

N.B. Patching the brick slip system may be noticeable in the short term due to the degree of weathering each slip has endured and slight colour variances in the pointing mortar. Brick slips should be left to weather in prior to assessing repair.



## 6.0 Wetherby System Products

Wetherby system products and ancillary items can be purchased through our trade counter, please contact:

Telephone: 01942 528354

Email: [tradecounterhq@wbs-ltd.co.uk](mailto:tradecounterhq@wbs-ltd.co.uk)

Each Wetherby trade counter provides a bespoke collection service and offers a wide range of leading branded products along with experienced members of staff who are on hand to help guide you when choosing the right materials for the job.



## 6.1 Wetherby SWI-FIX Spacers



Having invested in external wall insulation to enhance a property, it is important to ensure guarantees are protected through the correct installation of fixtures and fittings. Any items installed must not damage or crush the EWI system or allow water ingress into the system.

The Wetherby SWI-FIX products are an easy solution for fixtures such as hanging baskets, external lights, hose reels, satellite dishes, alarms, etc.

### Installation Guide:



Start with SWI-FIX



Mark the wall

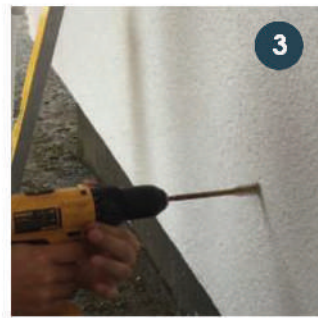

Drill 16mm hole

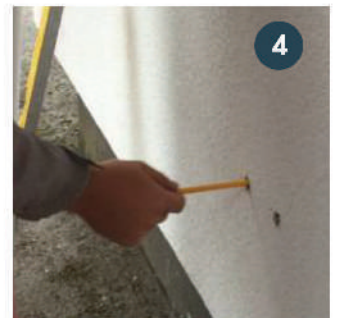

Measure depth to substructure

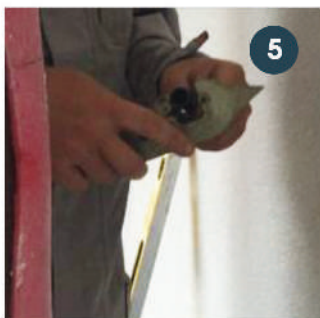

Cut tube to length

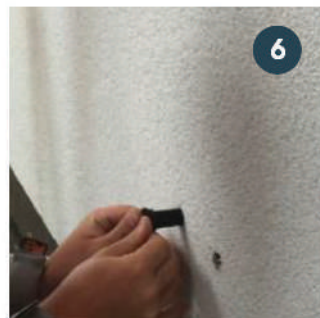

Place rubber & insert tube

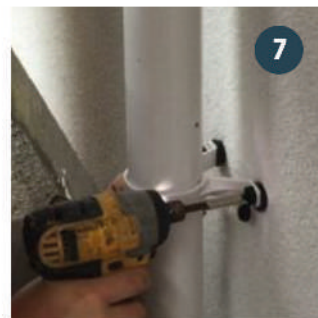

Insert plug, screw & fix through EWI

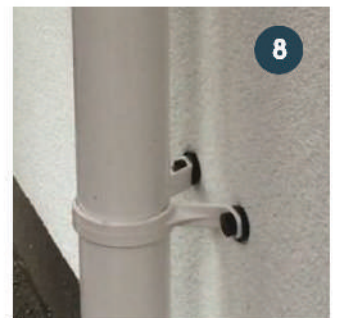

Installation complete



## 7.0 Wetherby Contact Information

### Technical Department

For technical queries on the operations and maintenance of the Wetherby Modular Insulated Brick Slip System please contact our technical department on the details below:

Technical Helpline:

Tel: 08458 382380

E-mail: [info@wbs-ltd.co.uk](mailto:info@wbs-ltd.co.uk)

### Trade Counter

For Wetherby products contact our trade counter on the details below:

Telephone: 01942 528354

Email: [tradecounterhq@wbs-ltd.co.uk](mailto:tradecounterhq@wbs-ltd.co.uk)

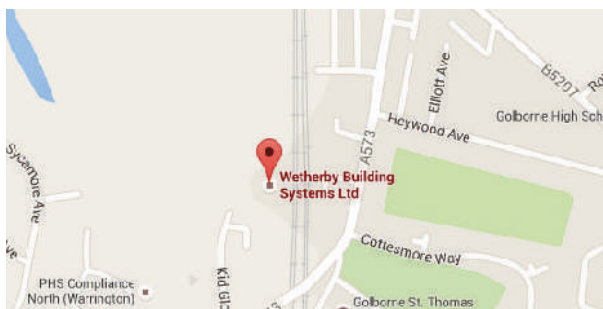

**Wetherby Building Systems Limited** \* Main Depot  
1 Kid Glove Road  
Golborne Enterprise Park  
Golborne  
Greater Manchester  
WA3 3GS  
Opening Hours: 07:30 - 16:30  
Main Tel: 01942 717100  
Main Fax: 01942 717101

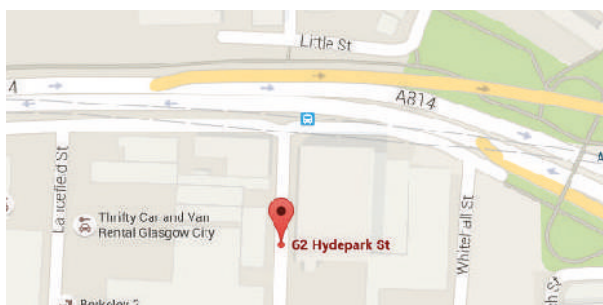

**Distribution Depot (Scotland)**  
62 Hydepark Street  
Glasgow  
Lanarkshire  
G3 8BW  
Opening Hours:  
Monday - Thursday: 07:30 - 16:30  
Friday: 07:30 - 14:30  
Tel: 0141 221 8115  
Fax: 0141 847 0767

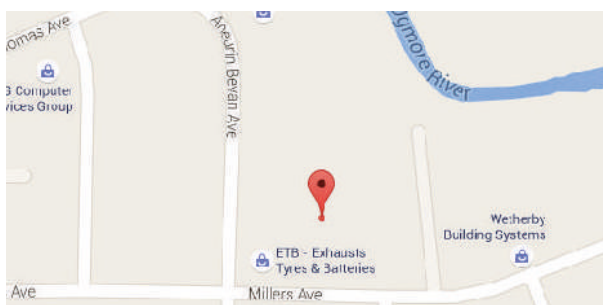

**Distribution Depot (South Wales)**  
Unit 17A  
Brynmenyn Industrial Estate  
Millers Avenue  
Bridgend  
CF32 9TD  
Opening Hours: 07:30 - 16:30  
Tel: 08450 946397  
Fax: 08450 946398