



# Building Safety Act / Gateway 2

## Non-Combustible Facade Systems

Wetherby Wall Systems Ltd | Part of  **ROCKWOOL** Group



# Certified Façade Systems

## What is Gateway 2?

Gateway Two serves as the second key milestone in the Building Safety Act's framework, taking place during the construction phase of higher-risk buildings. It is dedicated to ensuring that the approved design is implemented in practice while meeting all required safety standards and regulations.

## How can we assist you with your Gateway 2 Submission ?

- By offering a combination of Technical Expertise and Technical Support we can contribute to the successful implementation of the Building Safety Act and help ensure safer buildings for all.
- Our technical team is committed to making the Gateway 2 submission process as simple and effective as possible, ensuring compliance while maintaining high standards of safety and quality
- Streamlining the submission of the required technical documents in one pack makes the process more efficient for both the submitting party and the receiving regulatory authority.



# Certified Façade Systems

We have wide range of Non-Combustible External Wall Certified Façade Systems tailored to meet the needs of various building types, along with extensive options of complimenting decorative finishes.

EWI System	Certification			Decorative Finishes				
	KIWA	BBA	ETA	Clay Brick Slip	Acrylic Brick Slip	Silicone	Mineral	Dash
Masonry	✓	✓	✓	✓	✓	✓	✓	✓
Steel Frame Direct Fix	✓			✓	✓	✓	✓	
Steel Frame Cavity	✓	✓		✓	✓	✓		
Timber Frame	✓	✓		✓	✓	✓		

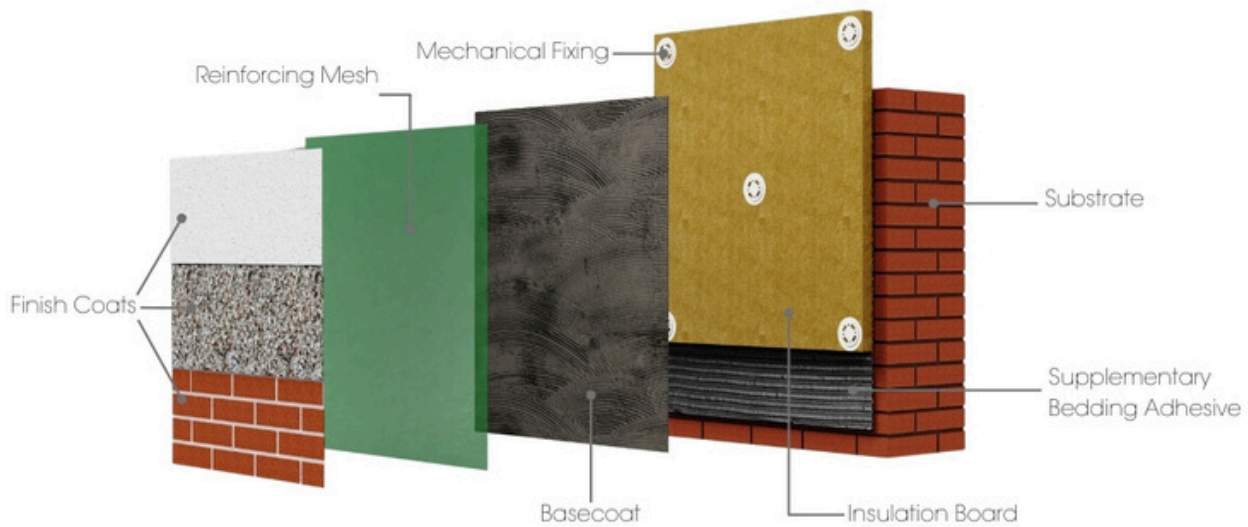

**System Build Up  
30 Year Durability**



# Certified Façade Systems

## Masonry

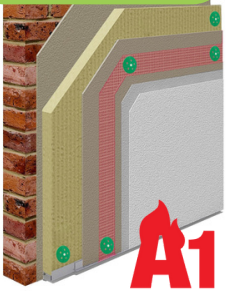

**A1**

Mineral Render

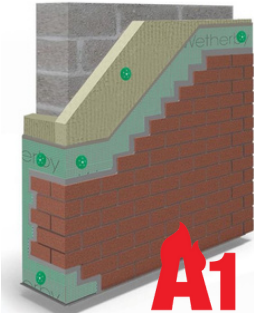

**A1**

Clay Brick Slip

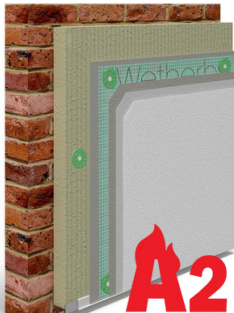

**A2**

Silicone Render

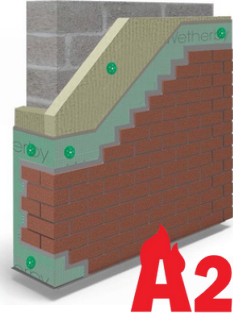

**A2**

Acrylic Brick Slip



**A2**

Dry Dash

## Steel Frame - Direct Fix

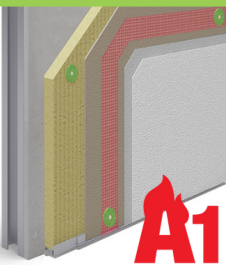

**A1**

Mineral Render

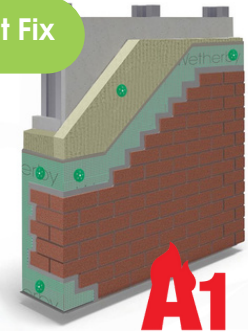

**A1**

Clay Brick Slip

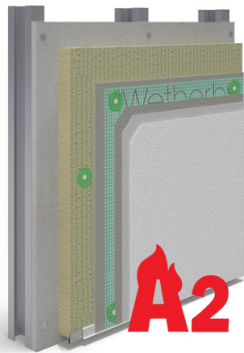

**A2**

Silicone Render

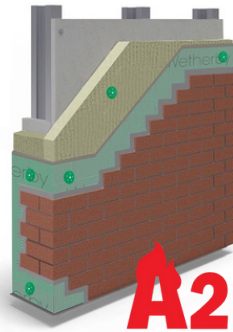

**A2**

Acrylic Brick Slip

## Steel Frame - Cavity

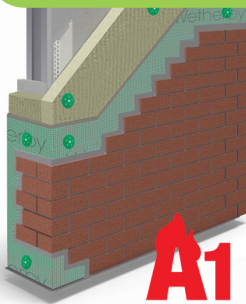

**A1**

Clay Brick Slip

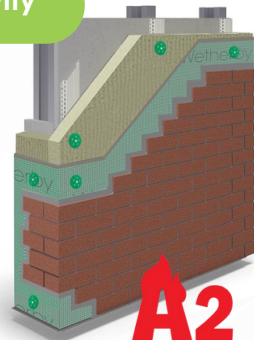

**A2**

Acrylic Brick Slip

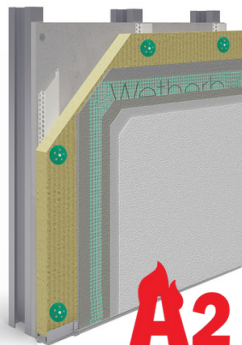

**A2**

Silicone Render

## Timber Frame

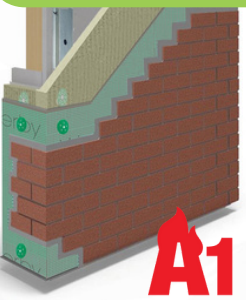

**A1**

Clay Brick Slip

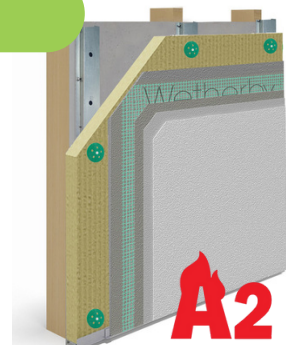

**A2**

Silicone Render

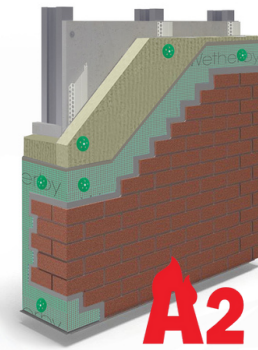

**A2**

Acrylic Brick Slip

**A1 & A2**  
**Fire Rated**  
**Façade**  
**Systems**





Get in touch!

We can simplify your Gateway 2 submission.



Call or WhatsApp

Steve Kilbride: 07874 399264



Email for more information

[gateway2@wbs-ltd.co.uk](mailto:gateway2@wbs-ltd.co.uk)